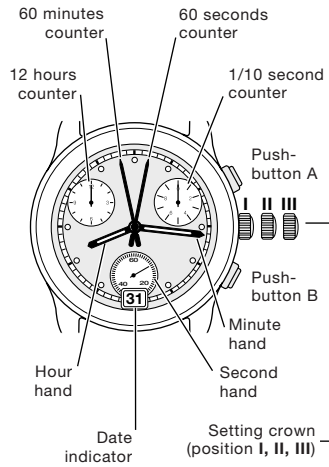
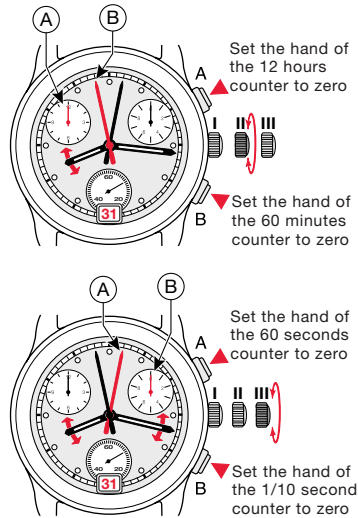
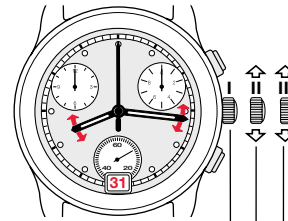

DISPLAY**A****Watch hands****SETTING THE COUNTERS TO ZERO****B****Setting crown in position II or III****SETTINGS****C****Crown 3 positions**

Normal running of watch
Correcting time-zone and correction of the date at every passing to midnight

Correcting time position:
stop second and correction of the date at every passing to midnight

Note :

Dietting crown in position II for longer 20 minutes (time could be lost).

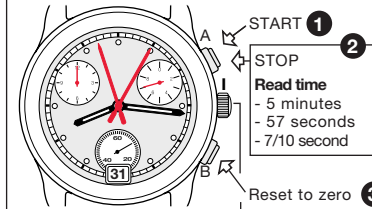
TIMING MODE**D****Simple timing function**

1 to 3 order of functions

WARNING

Before starting the time, put back the chronograph hands to their original position. If necessary, see paragraph SETTING THE COUNTERS TO ZERO.

GB

CHRONOGRAPH

ETA 251.262

ETA SA Manufacture Horlogère Suisse
depuis 1793

291 611 - 30.05.2005 / ETA / 03

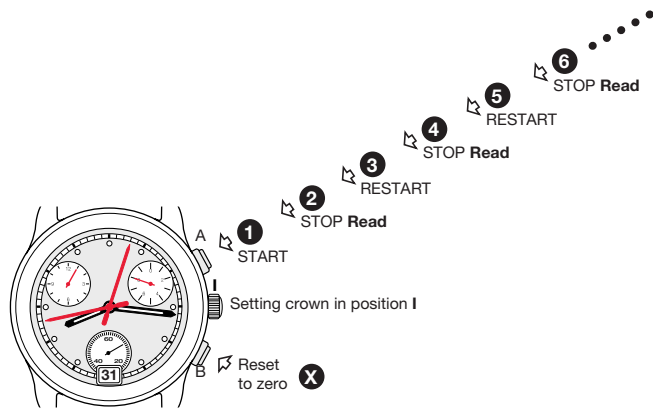
TIMING MODE**E****ADD function**

1 to X order of functions

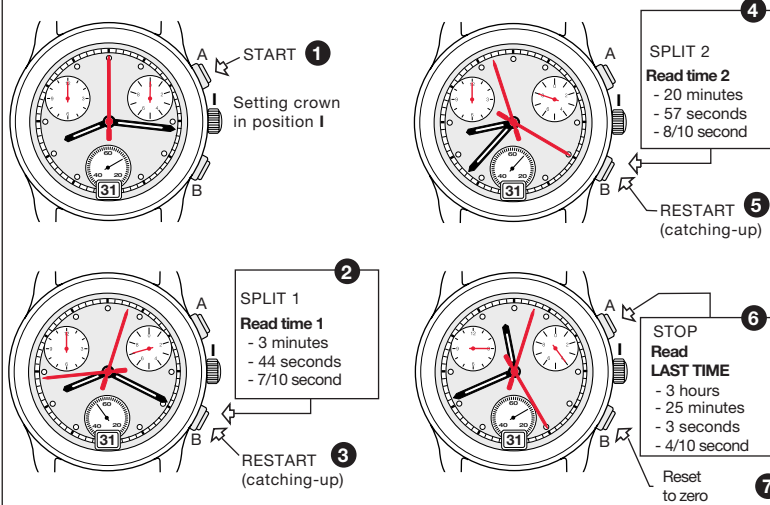
TIMING MODE**F****SPLIT-TIME or INTERMEDIATE TIME function**

1 to 7 order of functions