

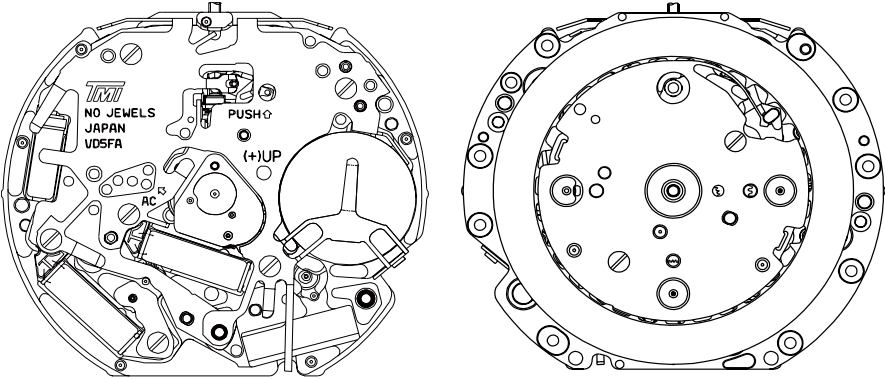



**TECHNICAL GUIDE  
&  
PARTS CATALOGUE**

**Cal.VD5FA**

**ANALOGUE QUARTZ**

Item	Cal. No.	VD5FA
Movement		
Movement size	Outside diameter	(φD) (3H - 9H) (12H - 6H) φ29.50 mm × 26.00 mm × —
	Casing diameter	(φD) (3H - 9H) (12H - 6H) φ28.80 mm × — × —
	Total height	4.57 mm
Time indication		3 Hands (Hour, Minute, Second) Chronograph (Minute, Second) Calendar
Driving System		Two pole stepping motor Step motor 2 pieces
Additional mechanism		Electronic circuit reset switch Second setting device [ Time ] Indicated by the Hour, Minute, Second hands [ Stop watch ] Up to 60 minute in 1 second split time
Antimagnetic		≥ 1600 A/m
Accuracy		Less than ± 20 seconds : Monthly rate at normal temperature range
Battery		SR920SW (SEIZAIKEN) Silver oxide battery φ9.5 × t 2.0 mm Battery life is approximately 3 years
Measuring gate by quartz tester		Use 10 second gate *Set the winding stem with crown at the normal position
Jewels		0 Jewel

Disassembling procedures Figs.	① ⇒ ④⑧	Lubricating : Types of oil	Oil quantity
Reassembling procedures Figs.	④⑧ ⇒ ①	 Moebius 9010  Moebius 9030  S-6	 Normal quantity

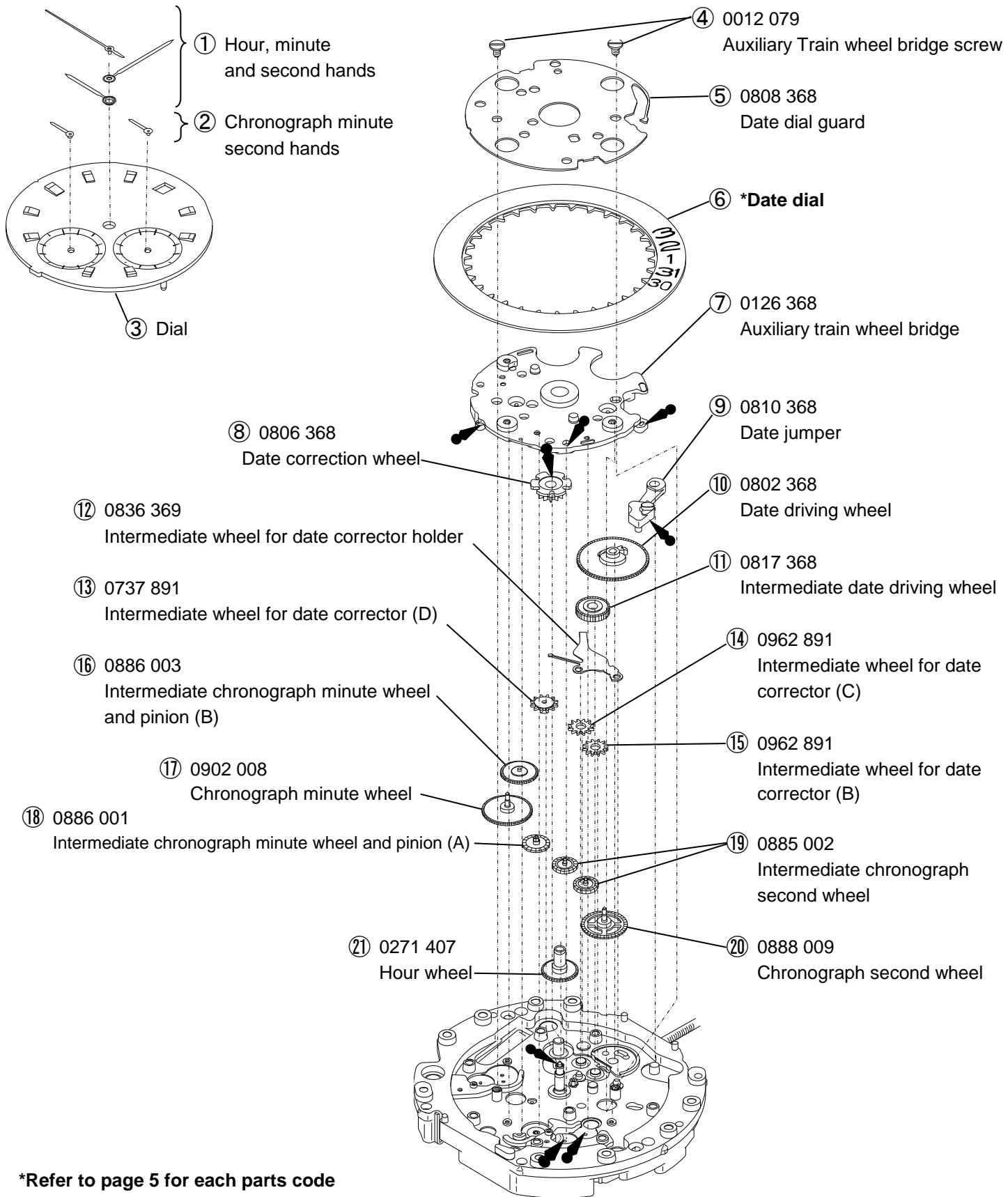

\*Refer to page 5 for each parts code

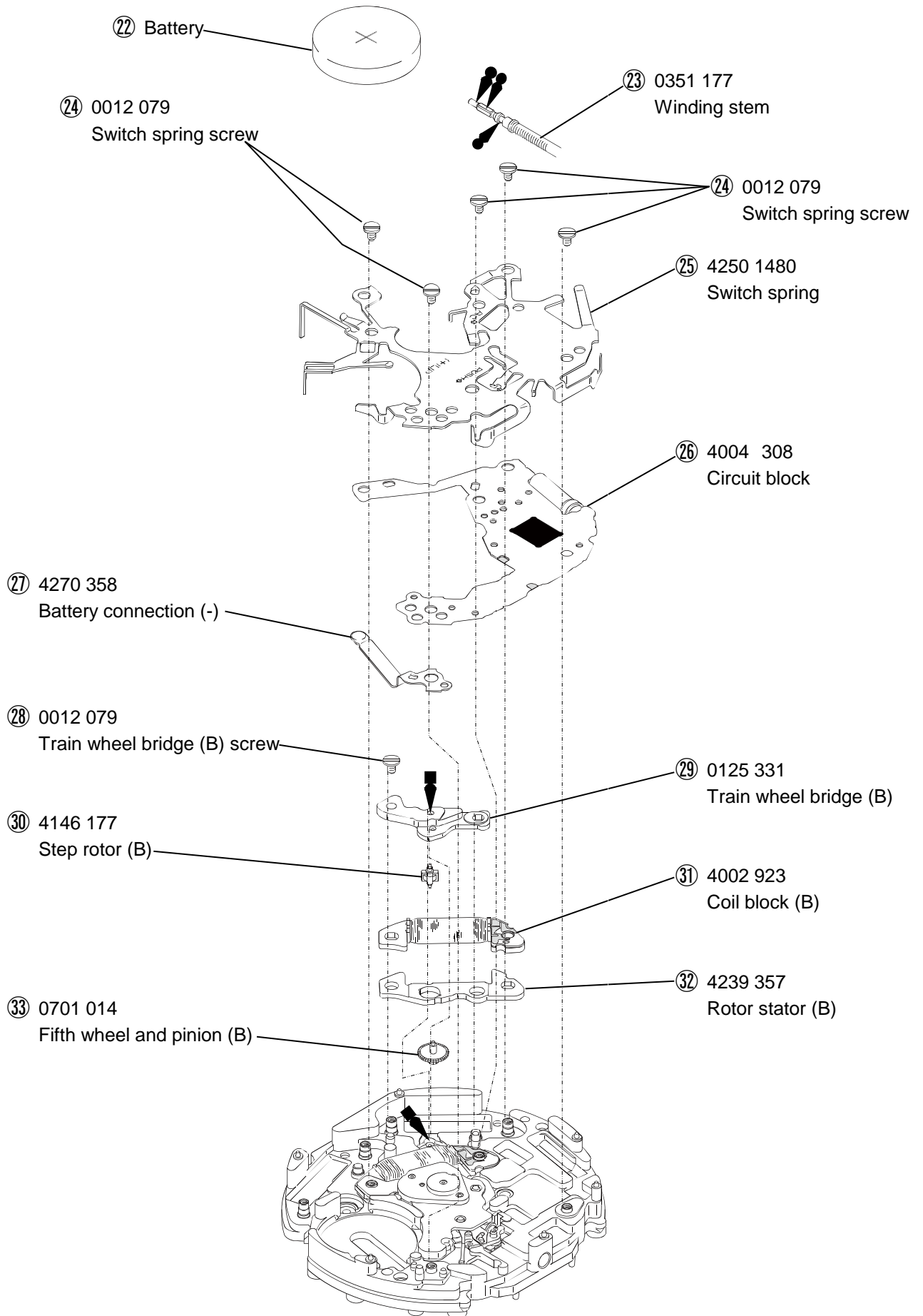

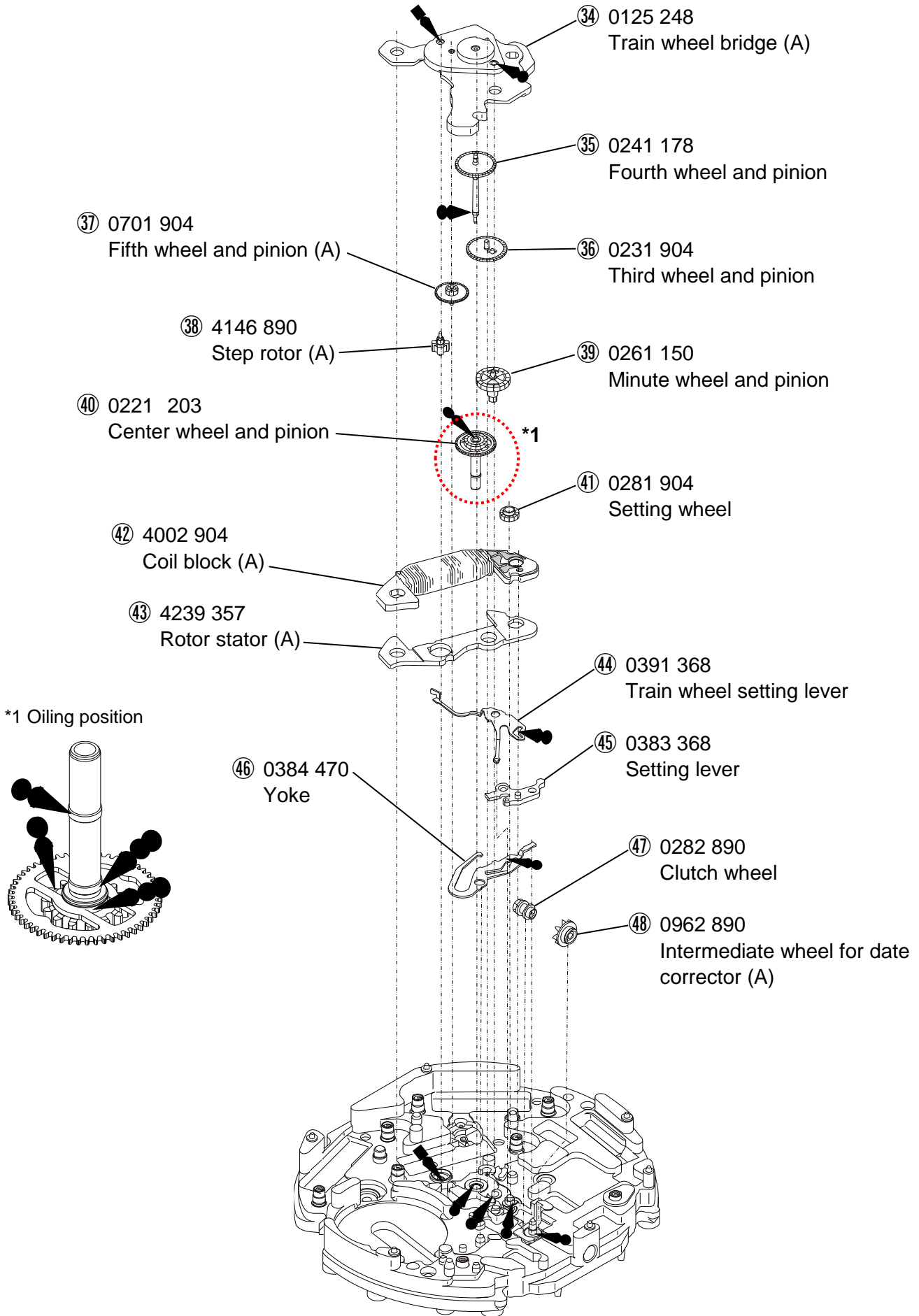

Remarks:

## ⑥ Date dial

Part code	Position of Crown	Position of date frame	Color of figure	Color of background
0878 220	3H	3H	Black	White

**\*All parts code are subject to change without notice.**

•The explanation here is only for the particular point of Cal.VD5FA

## 1.REMARKS ON INSTALLING THE BATTERY

- 1) After the battery is replaced with a new one or after the battery is reinstalled following the repairing procedures, Be sure to touch the short-circuit the AC terminal of circuit block and the switch spring with conductive tweezers to reset the circuit as illustrated at right.

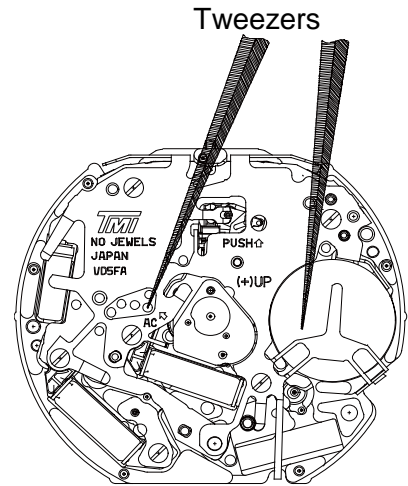

- 2) When the battery replaced with a new one, the time information stored in the built-in IC and the time indicated by the stopwatch hands do not correspond with each other. Reset the stopwatch hands to "0" position following the procedure below. If the stopwatch hands should move improperly, also follow the same procedure.

## ORDER

- ① Pull the crown out to the second click position.
- ② Keep the buttons "A" and "B" pressed at the same time more than 2 seconds, and then, release the buttons. The stopwatch second hand move back and returned to where it was.
- ③ Press button "A" or "B" to reset the stopwatch second and minute hands to "0" position.
  - \* By pressing button "A", the hands move counter clockwise.
  - \* By pressing button "B", the hands move clockwise.
- ④ Turn the crown to set the hour, minute hands to the desired time, and push the crown back to the normal position.

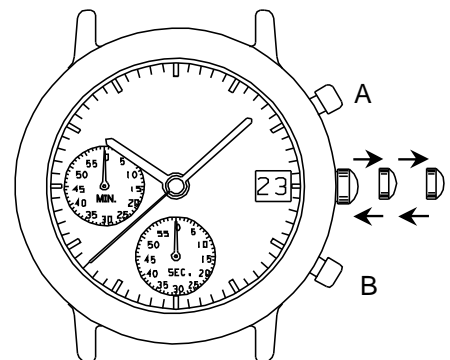

## 2.REMARKS ON DISASSEMBLING AND REASSEMBLING

### (1) Hand

- How to install the hands

Please put on the metal plate so as to avoid 6 protrusions.(Right figure: place of red circle)

\*install the hour, minute and second hands at the "12"o'clock position.

\*install the chrono minute and second hands at the "0"o'clock position.

### [ Reference ] The power of press hands

Minute & Hour Hands	< 5kg
Second Hand	< 5kg
Chrono Minute & Second	< 3kg

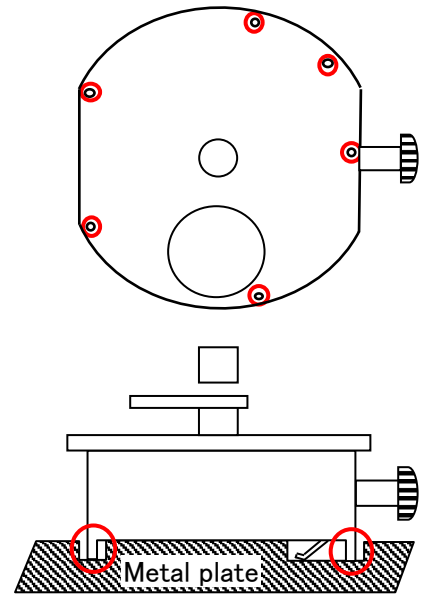

### (2) Battery

- How to install the battery

- ① Remove the hook of the switch springs battery clamp portion.
- ② Insert the battery sideways, and have the hook of the switch springs battery clamp portion catch the main plate.

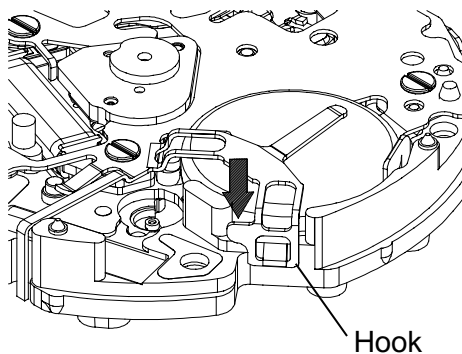

Battery clamp position

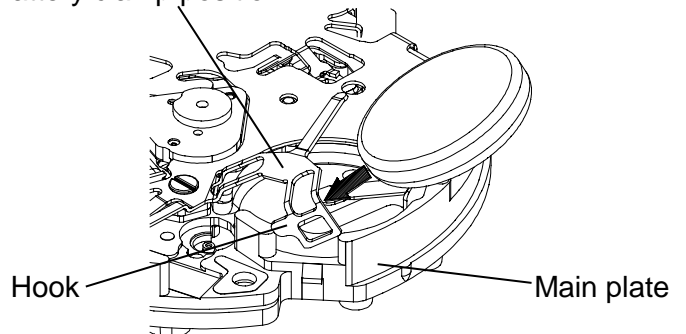

### (3) Winding stem

- How to remove

While pushing the indented portion of the arrow, pull out the winding stem.

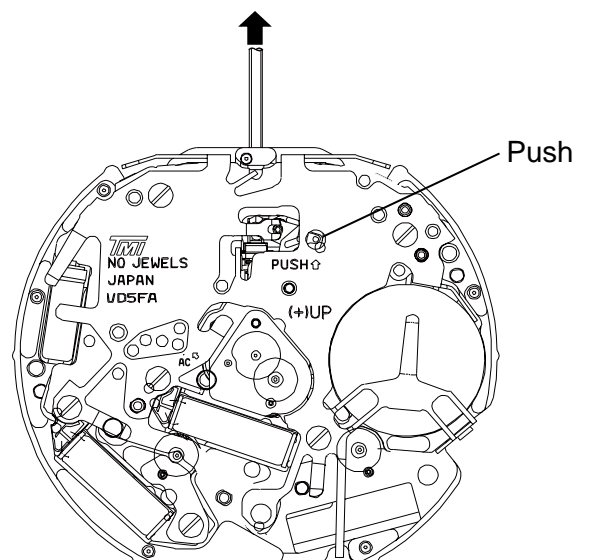



## DISPLAY AND CROWN / BUTTON OPERATION

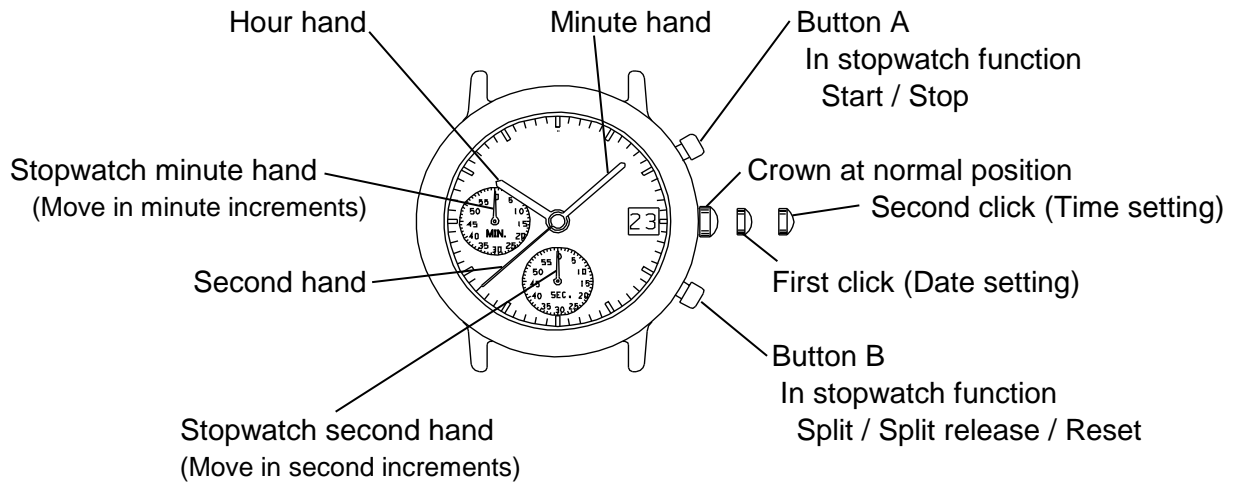

## ADJUSTING THE STOPWATCH HAND POSITION

Before setting the time, check if the stopwatch second and minute hands are in the "0"(12 o'clock) position.

\*if the stopwatch is in use, press the button in the following order to reset it, and then, check if the hands return to "0" position. (For details, see "HOW TO USE THE STOPWATCH")

- \* If the stopwatch is counting : A → B
- \* If the stopwatch is stopped : B
- \* If the split time is displayed : B → A → B

If either of the stopwatch hands are not in the "0" position, reset them following the procedure below.

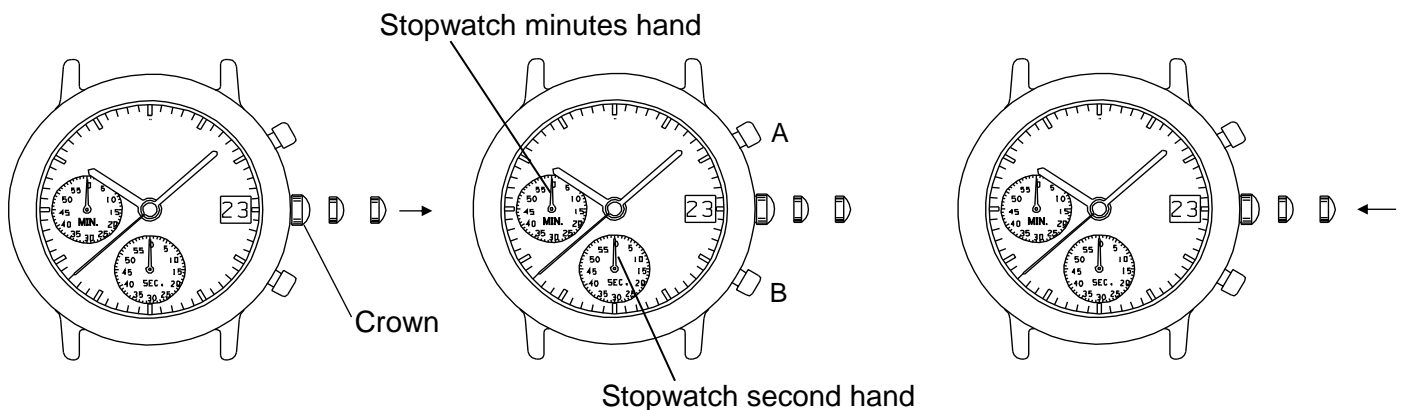

1.Pull the crown out to the second click.

2.Press button A or B to reset the stopwatch second and minute hand to "0"position.

\*By pressing button A the hands move counter clockwise.

\* By pressing button "B", the hands move clockwise.

3.Push the crown back to the normal position.

## TIME SETTING

\* Before setting the time, check that the chronograph measurement is stopped.

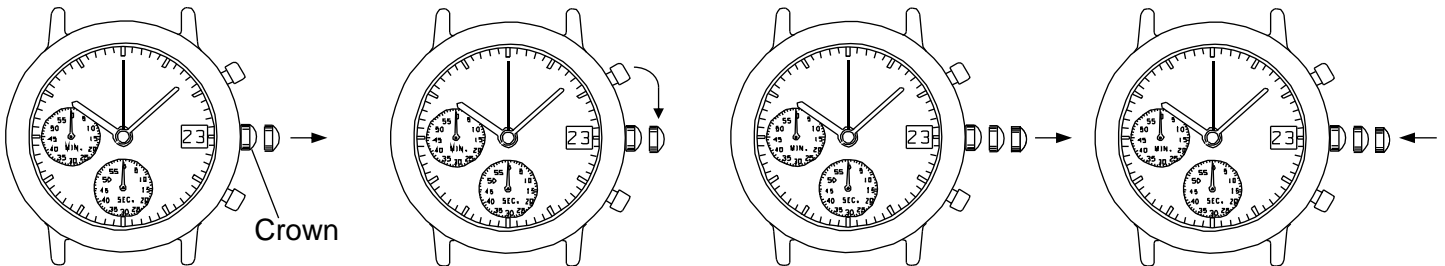

1. Pull out the crown to the first click.

2. Turn the crown clockwise until the previous day's date appears.

3. Pull out the crown to the second click when the second hand is at the 12 o'clock position. It will stop on the spot and advance the hour and minute hands by turning the crown. (Check that AM/PM is set correctly.)

4. Push the crown back in to the normal position in accordance with a time signal.

\*When the crown is at the second click position. Do not press any button. Otherwise, the chronograph hands will move.

\*Do not set the date between 9:00 P.M. and 1:00 A.M.

Otherwise, the day may not change properly. If it is necessary to set the date during that time period, First change the time to any time outside it, set the date and then reset the correct time.

## HOW TO USE THE STOPWATCH

- The measurement time is indicated by the stopwatch hands that move independently of the center hands.
- The stopwatch can measure up to 60 minutes in seconds.  
(The watch indicates the measured time in second increments by ignoring off the 1/10 seconds obtained.)

(Standard measurement)

Ex) 100 m race (Press the buttons in the following order A → A → B )

START → STOP (Finish) → RESET (Reset to "0'00")

stopwatch minute hand

stopwatch second hand

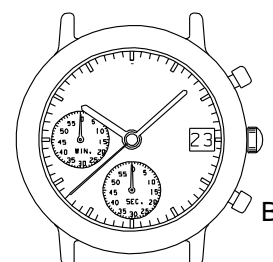
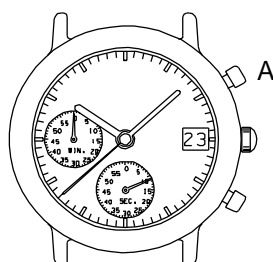
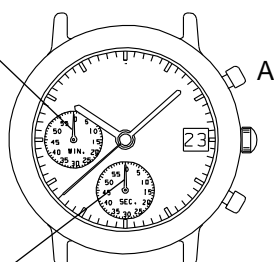

10 second

Ex) Basketball game (Press the buttons in the following order A → A / A → A → B )

START → STOP  
(Start of game) (Time out)

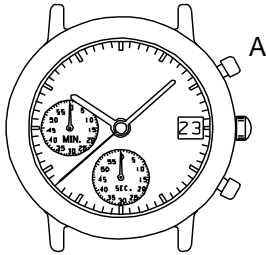

5 minutes 10 seconds

RESTART  
(Restart of game)

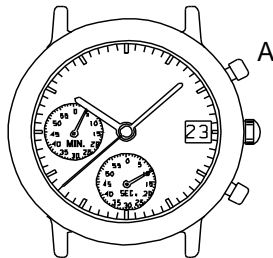

STOP  
(Game over)

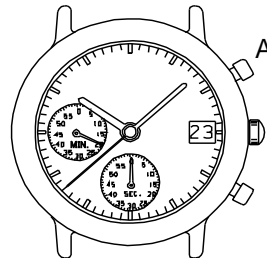

20 minutes 00 seconds

RESET

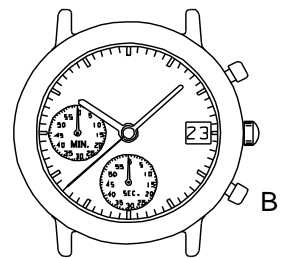

\*Restart and stop of the stopwatch can be repeated as many times as necessary by pressing button A.

(Split time measurement)

Ex) 5,000 m race (Press the buttons in the following order A → B / B → A → B )

START →

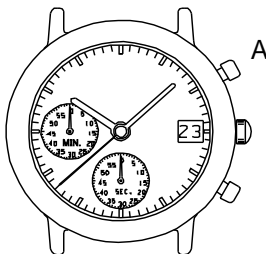

2 minutes 50 seconds

SPLIT /  
SPLIT RELEASE →

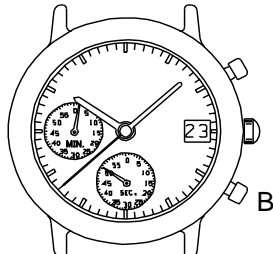

STOP →

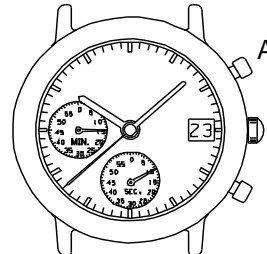

15 minutes 10 seconds

RESET

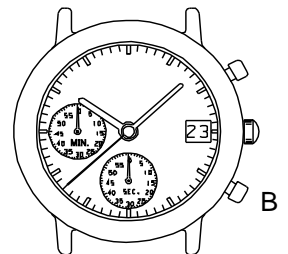

\* Measurement and release of the split time can be repeated as many times as necessary by pressing button B.